



AUDIBLE INFORMATION DEVICE

— INSTRUCTION MANUAL —

[CLICK HERE FOR
THE PARAKEET
RESOURCE HUB](#)



Part of the RightPath™ brand product line.

Version 0.18 1-22-25

CONTACT:

Call 800-662-6338 to talk to a Customer Service Representative.

HOURS:

8 AM to 5 PM (E.T.)
Monday through Friday



TABLE OF CONTENTS

PAGE
03 | **SECTION 1**
SAFETY INSTRUCTIONS
& INTRODUCTION

PAGE
04 | **SECTION 2**
PARAKEET
OVERVIEW

PAGE
06 | **SECTION 3**
INDICATOR
LIGHTS

PAGE
07 | **SECTION 4**
BATTERY
INFORMATION

PAGE
08 | **SECTION 5**
SENSOR
DETECTION ZONE

PAGE
09 | **SECTION 6**
PARAKEET
SET UP

PAGE
13 | **SECTION 7**
CALIBRATION
MODE

PAGE
14 | **SECTION 8**
BASE VOLUME
ADJUSTMENT

PAGE
16 | **SECTION 9**
PAUSING PARAKEET
FUNCTIONALITY

PAGE
17 | **SECTION 10**
BATTERY LIFE
INDICATION

PAGE
18 | **SECTION 11**
UPDATING THE
SOFTWARE

PAGE
22 | **SECTION 12**
CREATING Text-
to-speech

PAGE
30 | **SECTION 13**
LOCAL
RECORDING

PAGE
32 | **SECTION 14**
TROUBLESHOOTING



1.1 – SAFETY INSTRUCTIONS & HAZARD WARNINGS

⚠ WARNING WARNING ⚠

Parakeet can produce sounds over 100 dB.
Please use precautions and use appropriate safety protection

⚠ WARNING WARNING ⚠

Parakeet uses lithium-ion batteries. Please use the proper protocol when traveling/transporting.

1.2 – MANUAL OVERVIEW

This manual describes the operation of the Parakeet Audible Information Device (AID) system.

Upon reading this manual, you will be able to:

- » Power the unit on and off
- » Calibrate the system's sensor and automated decibel control
- » Set the device base volume
- » Update the software
- » Record audio locally
- » Create a text-to-speech message
- » Convert audio to a .WAV file
- » How to mount the unit
- » Understand the Parakeet's detection zone
- » Charge batteries

1.3 – FCC GUIDELINES

This equipment has been tested and found to comply with the limits for a Class B digital device, pursuant to part 15 of the FCC Rules. These limits are designed to provide reasonable protection against harmful interference in a commercial installation. This equipment generates, uses and can radiate radio frequency energy and, if not installed and used in accordance with the instructions, may cause harmful interference to radio communications. However, there is no guarantee that interference will not occur in a particular installation. If this equipment does cause harmful interference to radio or television reception, which can be determined by turning the equipment off and on, the user is encouraged to try to correct the interference by one or more of the following measures:

- » Reorient or relocate the receiving antenna.
- » Increase the separation between the equipment and receiver.
- » Consult the dealer or an experienced radio/TV technician for help.

1.4 – INTRODUCTION

Welcome to the PSS instruction manual for Parakeet™ Audible Information Device.

In this manual, we will discuss Parakeet's basic features and functions, how it works, and how to troubleshoot and maintain the device. We have also included all necessary parts lists and schematic drawings.

1.5 – TO PARAKEET OPERATORS

All Parakeet operators shall:

- » Be trained in Parakeet operations
- » Ensure the regular maintenance of Parakeet
- » Avoid all hazards that could cause injury or damage

Please contact our technical support department with any further questions at 800-662-6338.

1.6 – FUNCTIONS OF PARAKEET

Parakeet's primary functions are:

1. Identify incoming pedestrians via motion detection.
2. Announce a prerecorded message at a volume 5 dB above the surrounding noise. Parakeet's output sound is gated at 100 dB.

Patents: <http://bit.ly/3cHVTp8>



2.2 – WHAT COMES WITH PARAKEET

1. Parakeet
2. SD Card
3. Six Rechargeable Lithium-Ion Batteries
4. Battery Charger (Not Shown)
5. Tamper-Resistant Mounting Bolt
6. Tool for Tamper-Resistant Mounting Bolt
7. Tool for Tamper-Resistant Housing Bolt
8. Washer
9. Parakeet Manual QR Card



2.2 – KEY PARTS OF PARAKEET

FRONT:

- 1. Speaker Output Grate
- 2. Motion Sensor
- 3. Ambient Microphone
- 4. Case Latch

BACK:

- 5. Tamper-Resistant Screw
- 6. Product Label
- 7. Threaded Insert

INSIDE:

- 8. 3.5 mm Microphone Jack
- 9. Data Jack (Manufacturer Use Only)
- 10. SD Card Port
- 11. Serial Cable Port (Manufacturer Use Only)
- 12. Function Buttons and Indication Lights (F1 - F4)
- 13. On/Off Switch
- 14. Rechargeable 3.7 Volt Lithium-Ion Batteries
- 15. Parakeet Manual QR Label
- 16. Rubber Gasket

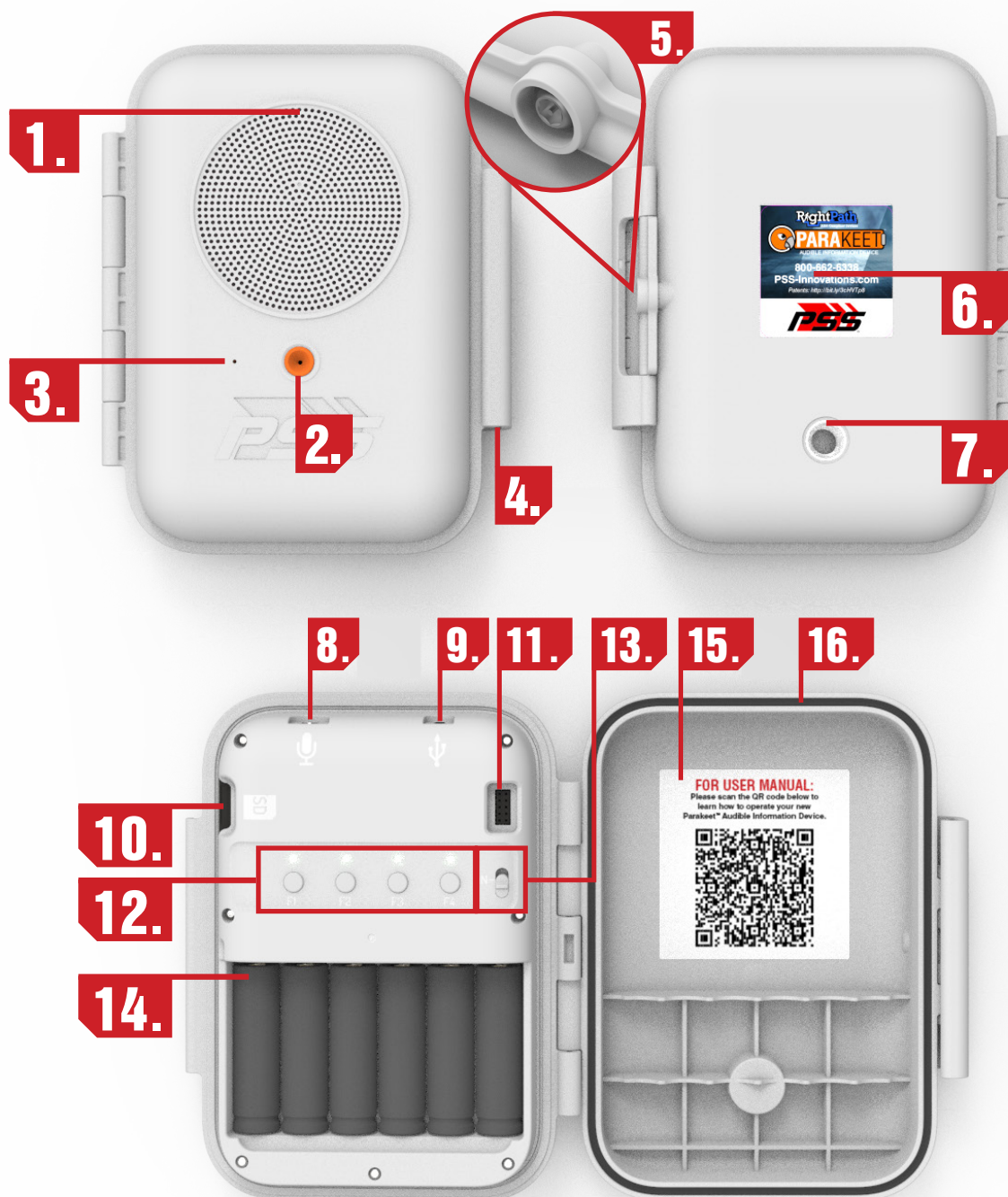

Sect. 03 INDICATOR LIGHTS

PARAKEET INDICATOR LIGHT INDEX		
LEDs ACTIVE STATUS	DESCRIPTION	VISUAL INDICATION
All LEDs Solid Amber	Parakeet is booting up	
All LEDs Flashing Green	Parakeet has booted up and is ready for calibration	
All LEDs Solid Red	Parakeet is recording mic audio	
LED F1 Flashing Amber	Parakeet is calibrating	
LED F1 Flashing Green	Parakeet is active and sensing	
LED F2 Flashing Red	Movement detection deactivated	
LED F3 Flashing Amber	Volume up button pressed when volume adjust button not activated	
LED F4 Blinks Once Amber	Volume down button pressed when volume adjust button not activated	
LED F2 Flashing Amber	Parakeet is playing audio for volume adjustment	
LED F3 Flashing Green	Volume up button (F3) pressed and volume increased	
LED F4 Flashing Green	Volume down button (F4) pressed and volume decreased	
LED F4 Flashing Amber	Batteries are low, replace soon	
LED F4 Flashing Red	Batteries are critically low, replace immediately	
After Pressing And Holding The F2 Button For Four Seconds, LED F4 Flashes Red One To Five Times or Green six to Ten Times	To check Parakeet battery charge, press and hold the F2 button for four seconds. The F4 LED will flash either red or green in increments of 10% according to charge level. When the battery life is at 60% or higher, the F4 LED will flash green a corresponding amount of times, when it is below 60% it will flash red. Example: After holding the F2 button for four seconds, if the Parakeet has a 30% charge, the F4 light will flash red three times.	<p>10% - 50% 1-5x</p> <p>60% - 100% 6-10x</p>

PARAKEET INDICATOR LIGHT ERROR INDEX			
LEDs ACTIVE STATUS	DESCRIPTION	POTENTIAL FIX	VISUAL INDICATION
Upon Booting Parakeet, LED F2 Flashing Red	No SD Card Detected	Check to see if the SD card is inserted and mounted fully	
Upon Booting Parakeet, LED F3 Flashing Red	Ambient Microphone Not Detected	Reboot the Parakeet. If the error persists, there is a hardware issue. Contact PSS.	
Upon Booting Parakeet, LED F4 Flashing Red	Ultrasonic Sensor Not Detected	Reboot the Parakeet. If the error persists, there is a hardware issue. Contact PSS.	

4.1 – BATTERY LIFE

⚠ WARNING WARNING ⚠

When traveling by air, whether personally or shipment, the batteries in Parakeet MUST be removed from the unit. If traveling personally with Parakeet, the batteries must be stored in carry-on luggage.

⚠ NOTICE NOTICE ⚠

Upon receiving your Parakeet, the batteries will be uncharged. Please fully charge the batteries before first use.

Parakeet battery life is dependent on volume, frequency of audio playing, temperature, and length of message. The expected battery life is two weeks.

Variables that affect battery life:

- » Temperature - Excessive heat or cold can drain the battery quicker than normal.
- » Frequency of activation - The more activations (the more people approaching the unit), the shorter the battery life will be.
- » Length of message - The longer the voice message, the more battery drains with each activation.
- » Volume - Auto modulates its volume to five decibels over background noise. This conserves battery while ensuring the message is audible.

4.2 - LOW BATTERY INDICATOR

The unit will begin playing "Low Battery" when it reaches 20% battery life. See section 10 for more information.

Batteries are removable and rechargeable.

4.3 - BATTERY SPECIFICATIONS

Each Parakeet uses six 3.7 Volt 18650 lithium-ion rechargeable batteries (P/N AID-HB06-01). The number 18650 refers to the size—18 mm wide and 65 mm long.

These batteries are not readily available at a local hardware store, to purchase more, contact PSS at 800-662-6338.

The charger charges six batteries at one time. It takes approximately four hours for the batteries to fully charge.



Sect. 05 SENSOR DETECTION ZONE

5.1 – HORIZONTAL DETECTION

Pedestrians will be detected up to approximately 13-feet away and up to a 8-foot wide area.

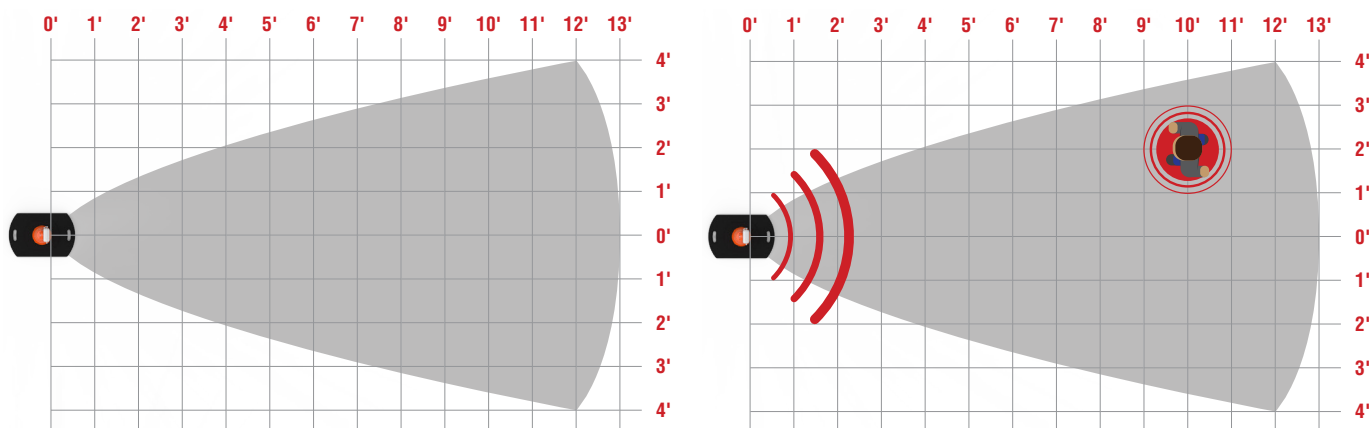

5.2 – KEY FEATURES

- » Detects multiple pedestrians and plays messages accordingly
- » Detects pedestrians and plays messages only as they approach the unit, not as they walk away or across
- » Detects surrounding sound in the vicinity of the unit and adjusts volume above the base volume accordingly
- » Supports local message recording

5.3 – SENSOR MAINTENANCE

To ensure that your Parakeet activates when a pedestrian enters the detection zone, the sensor must be clean. To clean the sensor, take a cotton swab and gently clear the debris away from the sensor. Do not use any compressed air or any sharp objects as they may damage the water-resistant seal in the sensor.

Sect. 06 PARAKEET SET UP

STEP 1

Use the **tool (A)** provided to open the latch by inserting the bit into the **tamper-resistant screw (B)** and loosening it.
NOTE: Do not remove the screw completely.

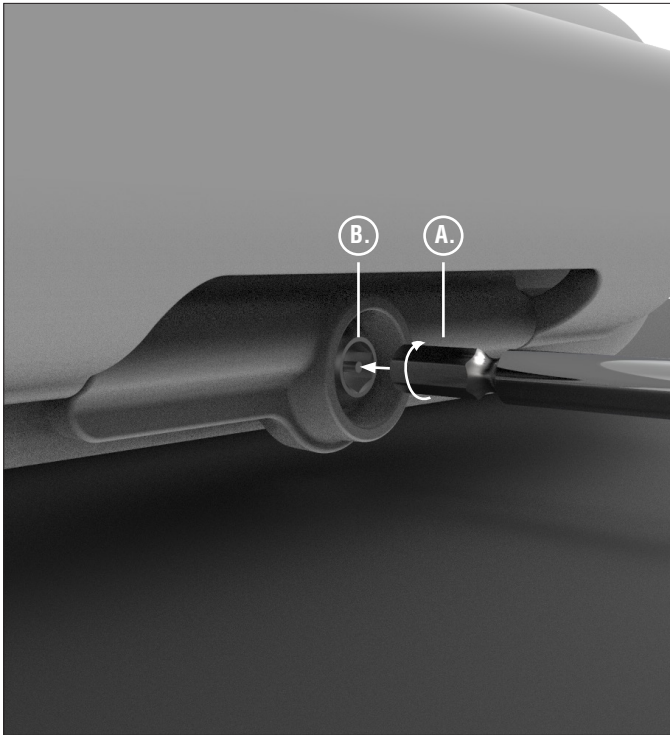

STEP 2

Pull the bottom of the **front cover latch (C)** away from the **Parakeet case (D)**.

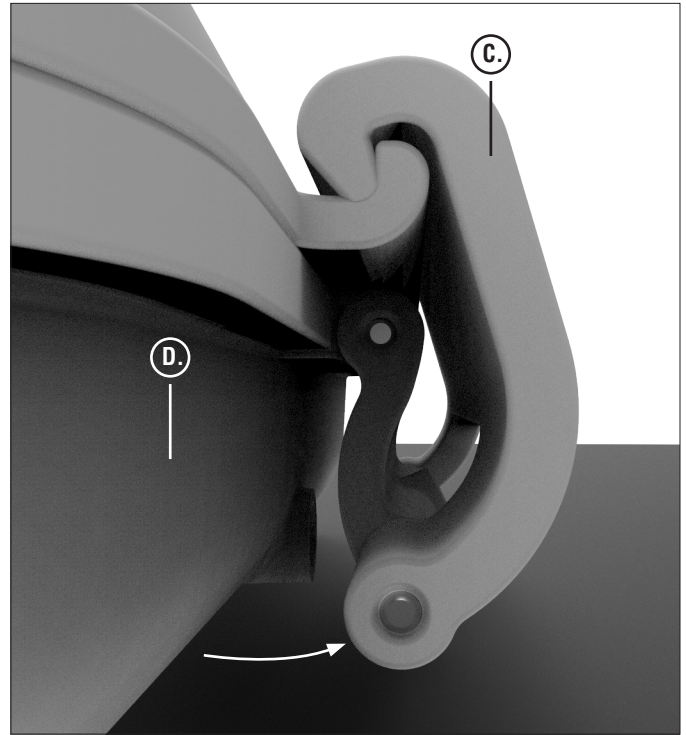

STEP 3

Then lift the **front cover latch (C)** to the right to release the **front cover (E)**.

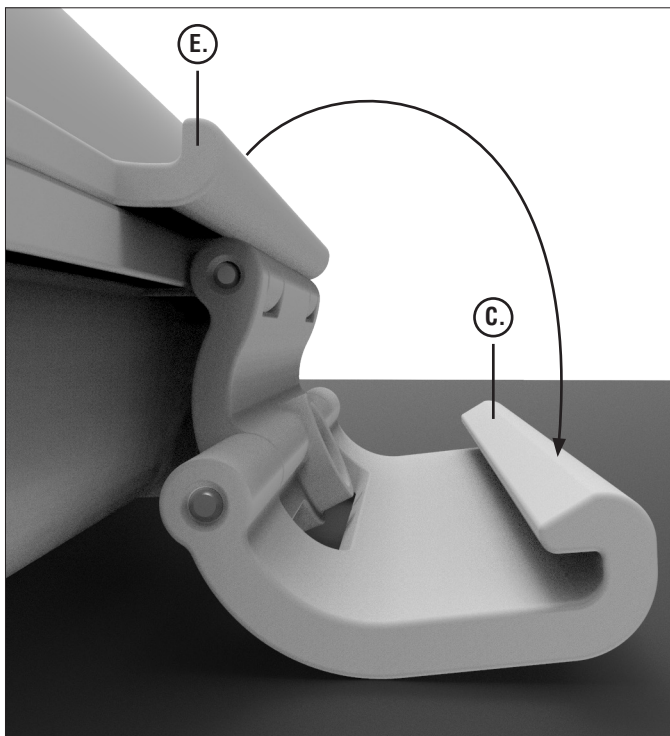

STEP 4

Open the **front cover (E)**. Ensure the **power switch (F)** is in the off position. Remove the protective tape that is covering the sensor and the SD Card.



Sect. 06 PARAKEET SET UP

STEP 5

Take the side of the **battery (G)** with the negative contact and push it up against the **spring (H)** located on the top of the battery slot. Push the positive side down making contact with bottom of the battery slot. Repeat for the five other batteries. **NOTE:** Be aware of the battery polarity. Incorrect usage will lower the battery life.

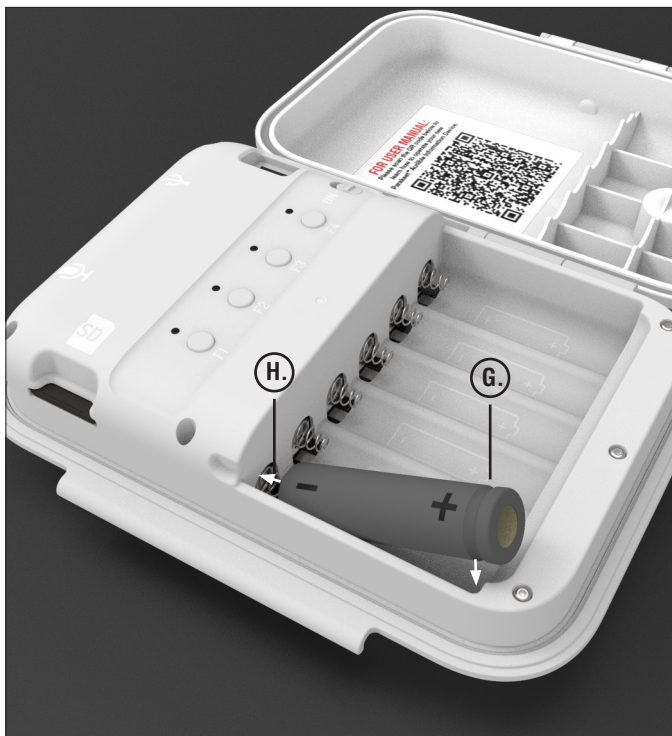

STEP 6

Pivot the **front cover (E)** to the right making contact with the **back cover (I)**. Lift the **front cover latch (C)** over the lip on the front cover. Push the bottom of the front cover latch towards the back cover, snapping into place.

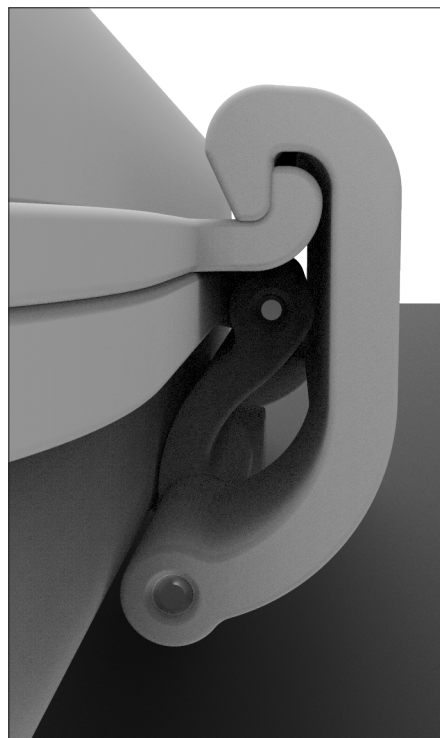
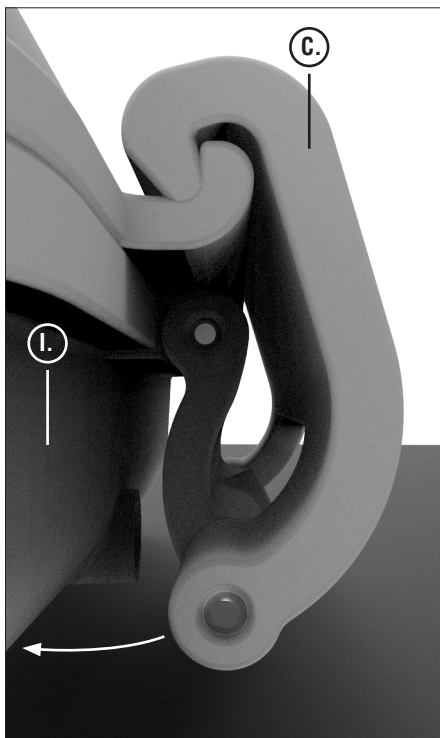
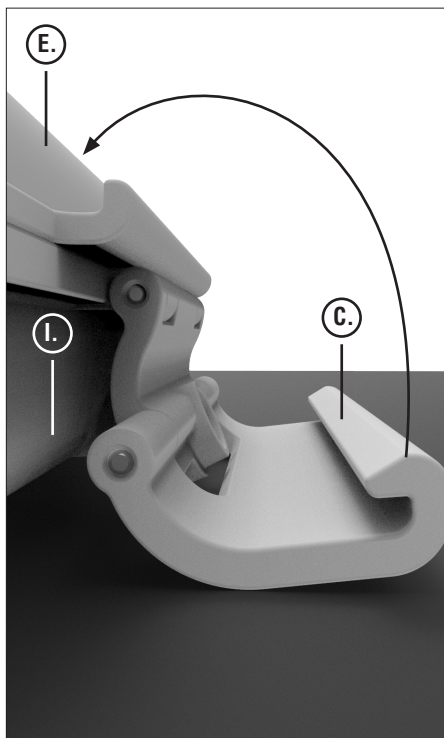

Sect. 06 PARAKEET SET UP

STEP 7

Place the **Parakeet (J)** on the flush side of the **traffic safety device (K)**. Insert the provided **tamper-resistant bolt (L)** through the washer **(M)** and the traffic control device and into the **threaded insert (N)** on the Parakeet and tighten with the provided **tool (O)**.



STEP 8

Place the mounted Parakeet in the work zone where it will be stationed. **NOTE:** Ensure there is an area that is free of moving objects in front of the unit as much as possible. This ensures that the unit has an unobstructed path for calibration of the ultrasonic sensor.

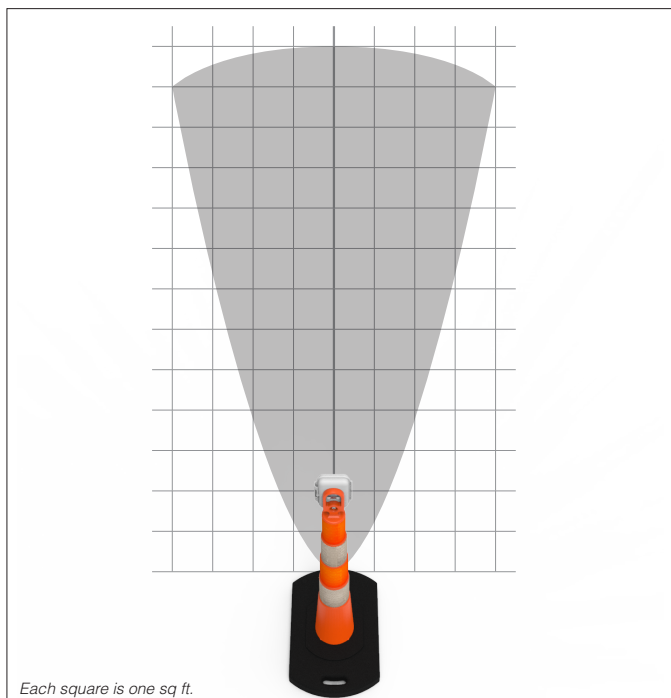

STEP 9

Open the unit and slide the **power switch (F)** up into the on position.

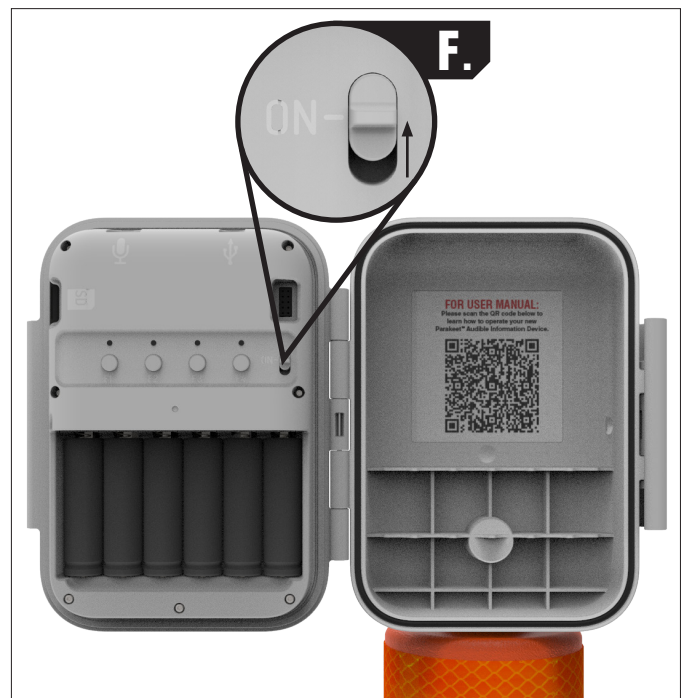

Sect. 06 PARAKEET SET UP

STEP 10

Wait approximately 4-5 seconds for the 4 LED lights to flash red once and then green twice. The F1 light will then begin flashing green. The Parakeet is working from its previous calibration. PSS recommends recalibrating the Parakeet.



NOTE: The Parakeet comes with a base message of "Congratulations on activating your new Parakeet audible information device by PSS. For instructions on programming the device, please consult the Parakeet manual by scanning the QR code on the inside of the Parakeet housing.". If a different message is desired, see section 12 for instructions on creating a text-to-speech message or section 13 to record a message locally.

Sect. 07 CALIBRATION MODE

STEP 1

To enter the calibration mode, press the **F1 button (P)**. When the unit enters calibration mode, the LED light above the F1 button will flash red. Press the F1 button again and the F1 light will quickly flash amber.

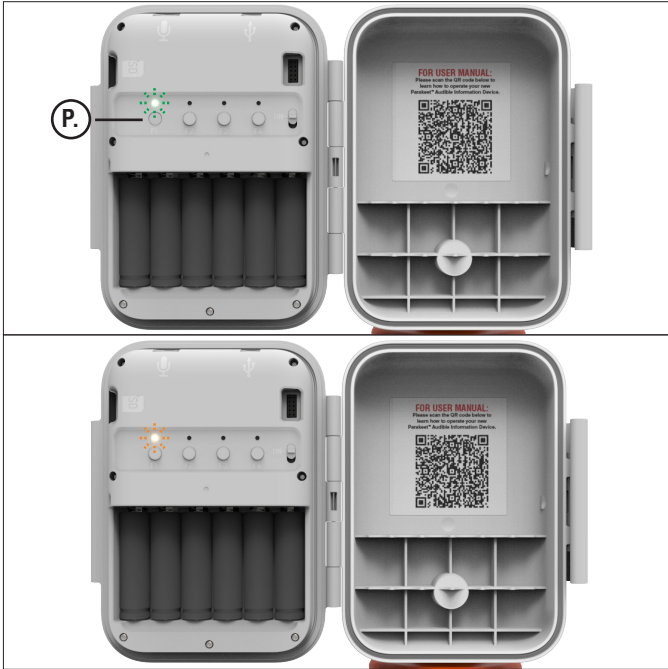

STEP 2

Once the F1 amber light is quickly flashing, close the Parakeet housing unit immediately and stand behind the device to allow for a clear path of sensor detection, free of moving objects and pedestrians. Depending on the surrounding area and noise level, calibration will take between 10-30 seconds to complete.

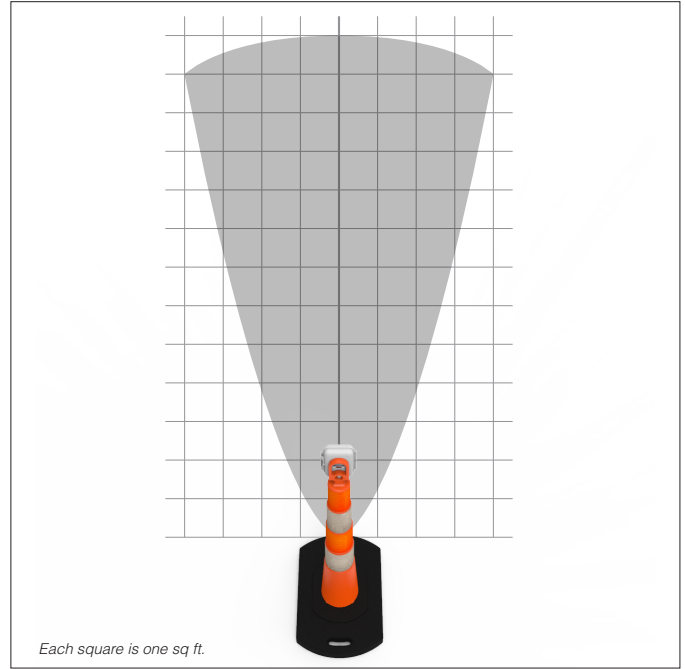

STEP 3

Once calibration is complete, the unit will play the message "calibration complete".



STEP 4

Once the Parakeet is calibrated, the unit should begin motion detection. To double check, open the unit and check that the LED light above the **F1 button (P)** is flashing green.



Sect. 08 BASE VOLUME ADJUSTMENT

NOTE: Parakeet will play at a level 5db above surrounding noise levels, with a base volume pre-set as the lowest level. To adjust the base volume, follow the instructions below.

STEP 1

Press the **F1 Button (P)** to pause the unit, then press the **F2 button (Q)** to enter volume adjustment mode. This mode will cause the main audio to continuously play, allowing you to adjust the volume accordingly using the **F3 and F4 buttons (R and S)**. As audio is being played the LED above the F2 button will continuously flash red.

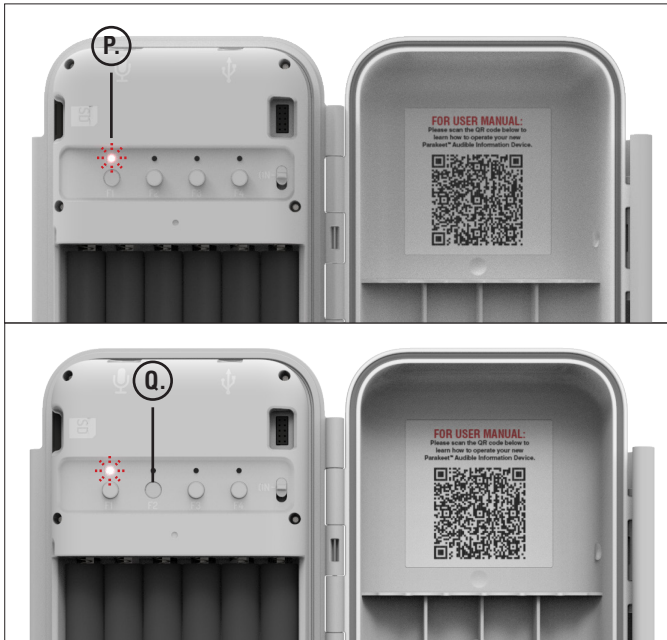

STEP 2

Pressing the **F3 button (R)** will increase the volume, and the **F4 button (S)** will decrease the volume. The LED light above the F3 and F4 buttons will flash green when pressed.

NOTE: If the F3 or F4 buttons are pressed before entering the volume adjustment mode, the volume will not change.



STEP 3

When you are satisfied with the base audio level, press the **F2 button (Q)** to exit volume adjustment mode. **NOTE:** Parakeet will auto-adjust to be louder than the ambient noise but no lower than the base volume set by the user.

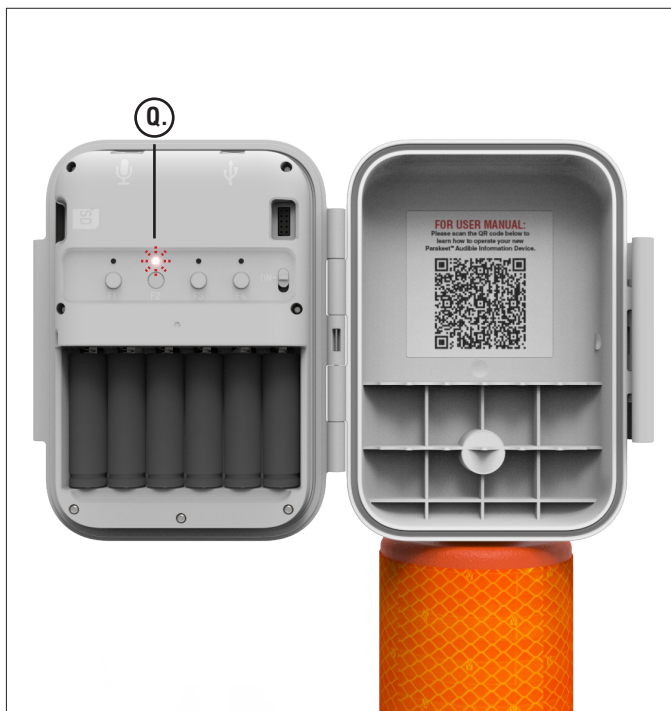

STEP 4

Press and hold the **F1 button (P)** for four seconds to resume detecting from the previous calibration. PSS recommends recalibrating your Parakeet after adjusting the volume. For more information on the calibration process, see section 7.



Sect. 09 PAUSING PARAKEET FUNCTIONS

STEP 1

In the event that you have repeated authorized motion in front of the Parakeet, users may elect to pause the Parakeet. To pause the functionality of your Parakeet without turning the power off, press the **F1 button (P)** once. The F1 LED will flash red. In this mode, the Parakeet will not play a message.

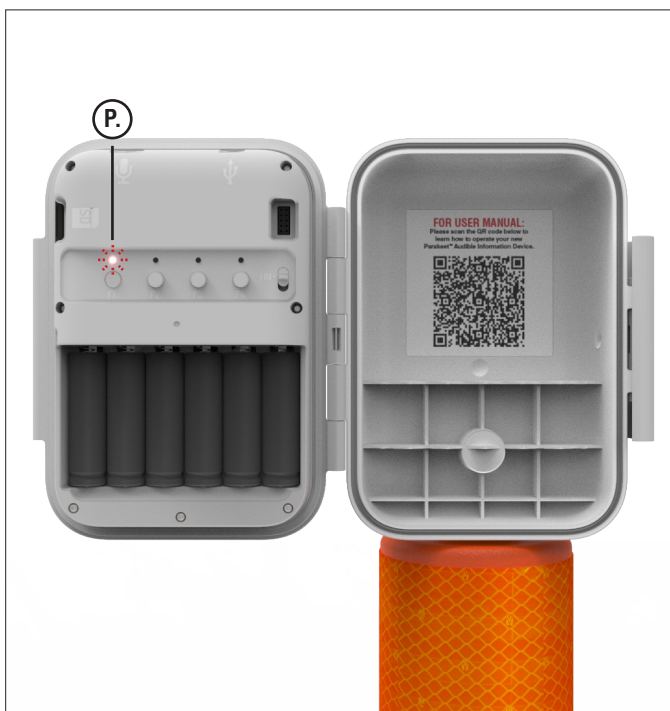

STEP 2

Once you are done in this mode, PSS recommends recalibrating your Parakeet. For more information on the calibration process, see section 7.

To resume from a previous calibration state, press and hold the **F1 button (P)** for four seconds. The F1 LED will begin flashing green.



STEP 1

To check the battery life of your Parakeet, press and hold the **F2 button (Q)** for four seconds. The F4 LED will flash in increments of 10%. When the battery life is at 50% or lower, the F4 LED will flash red a corresponding amount of times. If the battery life is 60% or above, the F4 LED will flash green a corresponding amount of times. For example: If the battery indication process was initiated by the user and the F4 LED flashes red four times, the battery life is at 40%. Or if the battery indication process was initiated by the user and the F4 LED flashes seven times, the battery life is at 70%.



BATTERY PERCENTAGES

NUMBER OF FLASHES	1	2	3	4	5	6	7	8	9	10
BATTERY PERCENTAGES	10%	20%	30%	40%	50%	60%	70%	80%	90%	100%



Sect. 11 UPDATING THE SOFTWARE

NOTE: Occasionally, it may be necessary to update your Parakeet's software. To ensure your Parakeet continues to operate on the most recent software update, contact your local PSS regional manager or PSS directly to receive automated software update messages via email. To update your software, you will need an SD card with storage between 4GB – 32GB. PSS recommends using two SD cards for updates, the original SD card that came with your Parakeet preloaded with software files (shown below in green), and another with the new software update on it (shown below in red).

Parakeet can be updated to the latest update without needing to install previous updates.

STEP 1

Turn the **Parakeet (J)** off by sliding the **power switch (F)** to the off position.

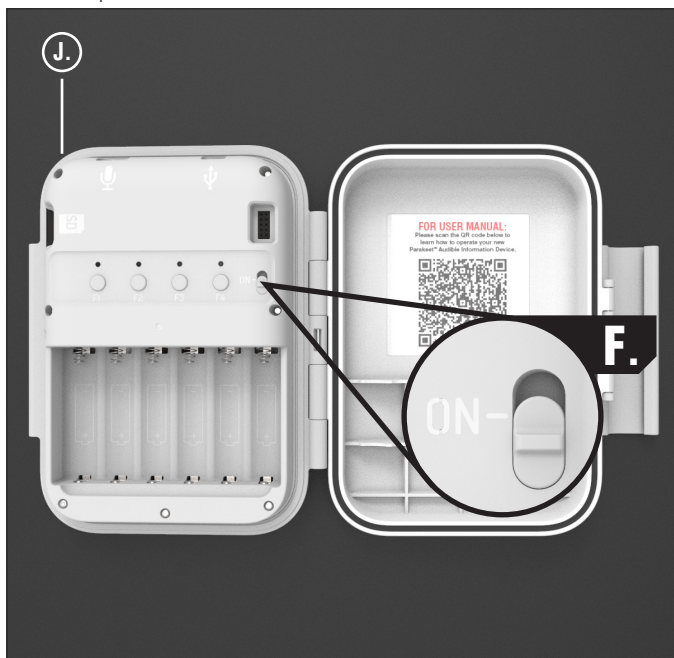

STEP 2

Press on the **Original SD Card (V)** on the left side of the unit.



STEP 3

Once the **Original SD Card (V)** clicks, pinch the edge of the SD Card and pull the card out.



STEP 4

Download the most recent software update [here](#). After downloading, right click and extract all. In the extracted folder, take the two files out and put them onto an empty SD card. When on the **Update SD Card (W)**, the update files should not be in a folder and should be the only files on the SD Card.

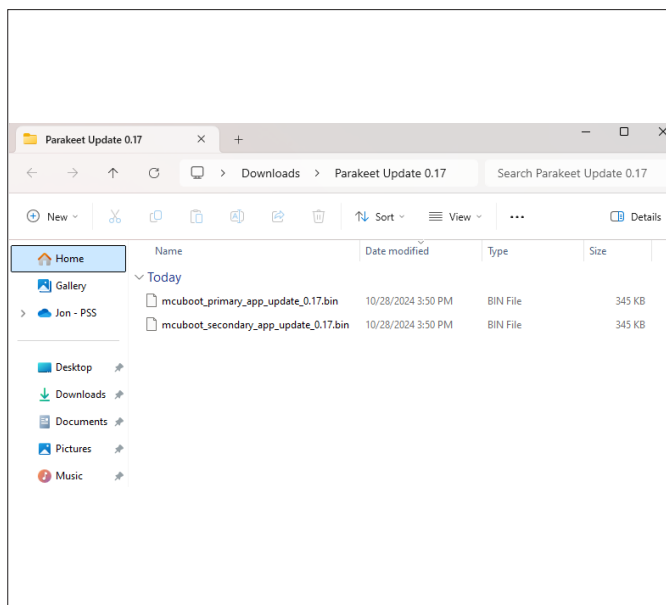

STEP 5

Insert the **Update SD Card (W)** with the software update on it. Press on the edge of the Update SD Card until it clicks then release.

**STEP 7**

All four **LED lights (P, Q, R and S)** will light up a steady red. While the LEDs are red, the unit is updating. Do not turn the Parakeet off or press any buttons. **F1 and F2 LED lights (P and Q)** will then turn a steady red for 15-30 seconds.

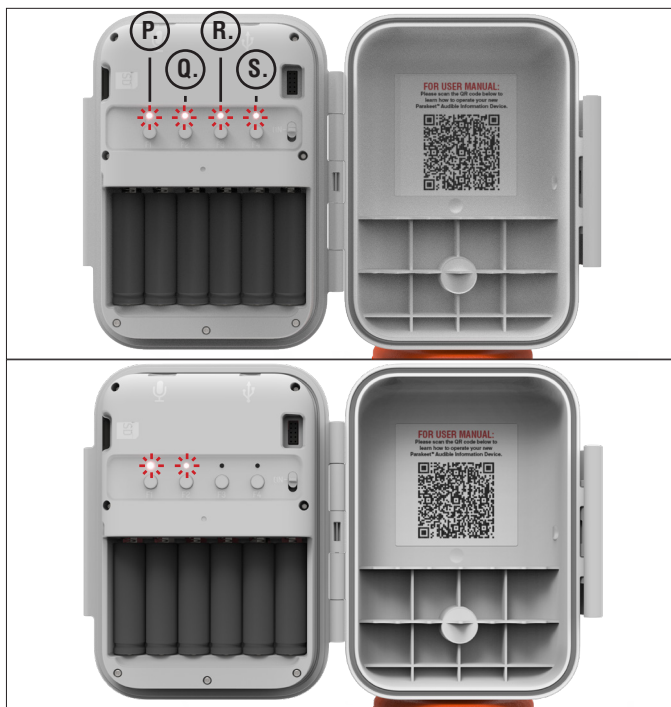
**STEP 6**

Slide the **power switch (F)** up into the on position. After booting, the updating process will immediately and automatically initiate.

**STEP 8**

The **F1 and F2 LED lights (P and Q)** will then light up a steady green for 15-30 seconds. After the lights turn green, the Parakeet will automatically reboot. Then the Parakeet will repeat the same light sequence again starting with all four **LED lights (P, Q, R and S)** lighting up a steady red. Once the Parakeet runs the light sequence for a second time, the updating process has been completed.



Sect. 11 UPDATING THE SOFTWARE

STEP 9

Slide the **power switch (F)** down into the off position.



STEP 10

Press on the **Update SD Card (W)** on the left side of the unit.



STEP 11

Once the **Update SD Card (W)** clicks, pinch the edge of the Update SD Card and pull the card out.

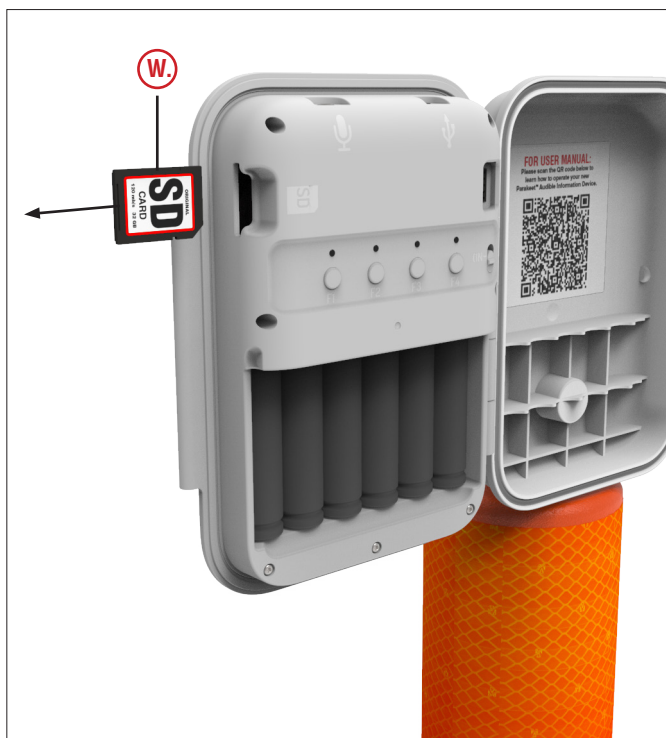

STEP 12

Insert the **Original SD Card (V)**. Press on the edge of the Original SD Card until it clicks then release.

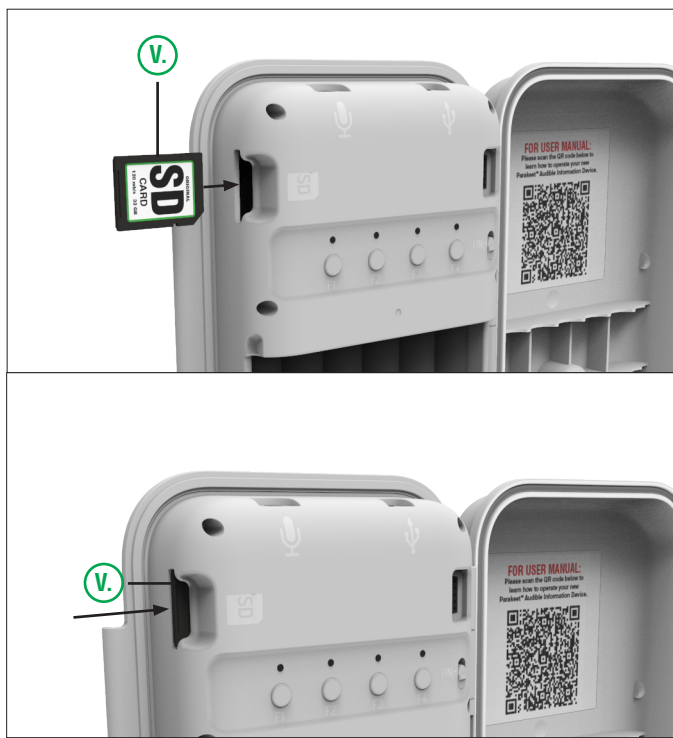
**STEP 13**

The Parakeet will now need to be re-calibrated. To recalibrate the unit, follow the instructions in the section 7.



Sect. 12 CREATING TEXT-TO-SPEECH

NOTE: To create text-to-speech for your Parakeet you will need the following: computer with Internet access, SD Card Reader (either built-in to the computer or as an external device (not provided)) and the SD Card inside of the Parakeet.

STEP 1

On your computer, open up your web browser and go to a text-to-speech program. PSS recommends using www.ttsmaker.com and following these instructions. **NOTE:** This section may use websites that are blocked on your workplace Internet. If you are experiencing a blocked site, please contact your IT team.

The screenshot shows the TTSMAKER website interface. At the top, it says "TTSMAKER Free Text to Speech" with a "Pro Upgrade" button. Below the header, there's a status bar indicating "Maximum characters 3000 remaining 3000 available" and an "Insert Pause" button. The main text input area is empty. On the right side, there's a "Language" dropdown menu set to "English". Below that, there's a "Voices" section with two options: "148 - Alayna-usUnited States Female (Hot + Unlimited)" and "777 - Miles-usUnited States Male Voice (Slow + Unlimited)". Each voice option has an "Example" button and a character limit. At the bottom right, there's an "Input verification code (identify the numbers in the picture)" section with a grid of numbers and a "Convert To Speech" button.

STEP 2

Type your message into the text box. For example: "Sidewalk closed ahead. Use pedestrian crossing." **NOTE:** All abbreviations must be spelled out for the text-to-speech to sound correct. (Example: St. must be Street, Ave. must be Avenue, etc.)

The screenshot shows the TTSMAKER website interface with the text "Sidewalk closed ahead. Use pedestrian crossing." entered into the main text input area. The status bar now shows "Maximum characters 3000 remaining 2953 available" and a "Clear Text" button. The "Language" dropdown is still set to "English". The "Voices" section remains the same. The "Input verification code" section is still present at the bottom right, with a grid of numbers and a "Convert To Speech" button.

STEP 3

Click on more settings.

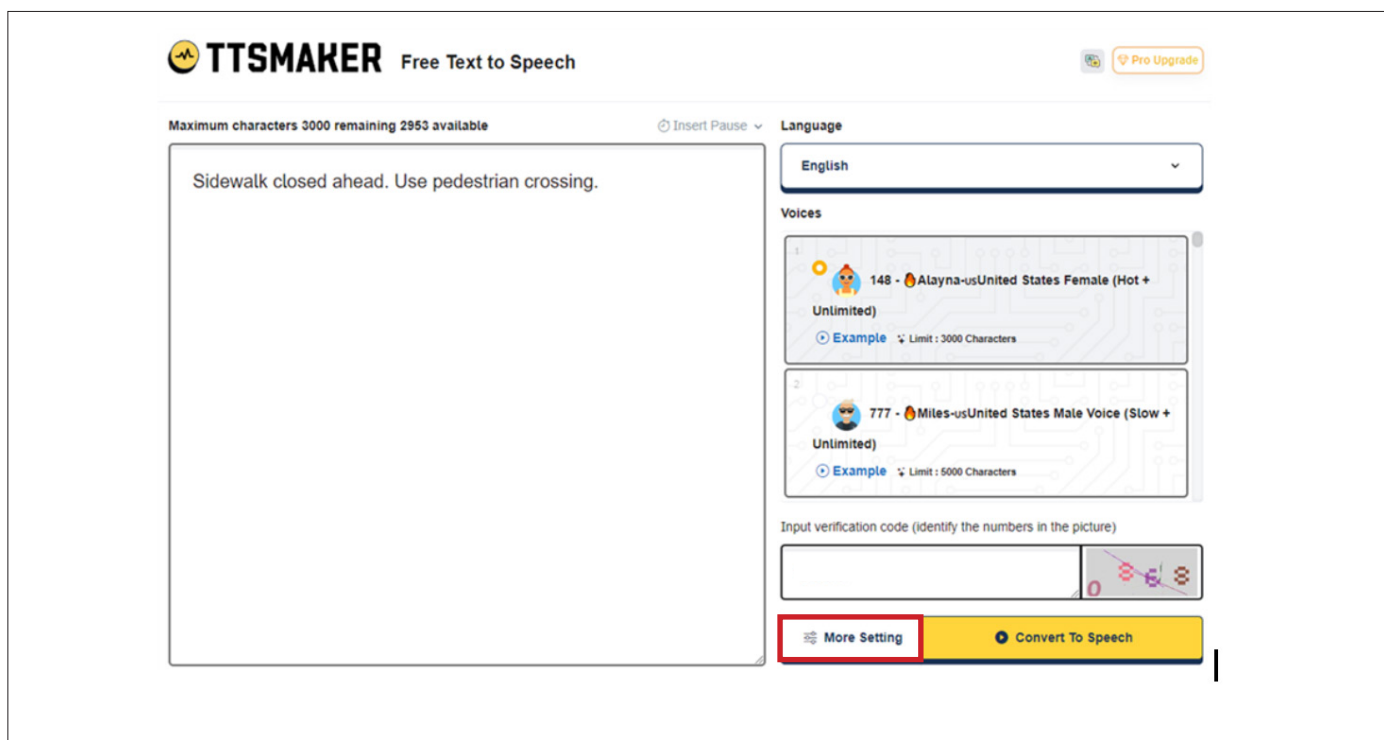

STEP 4

Scroll down to the Voice Volume section and click on it. Select 200% to increase the volume to an optimal level.

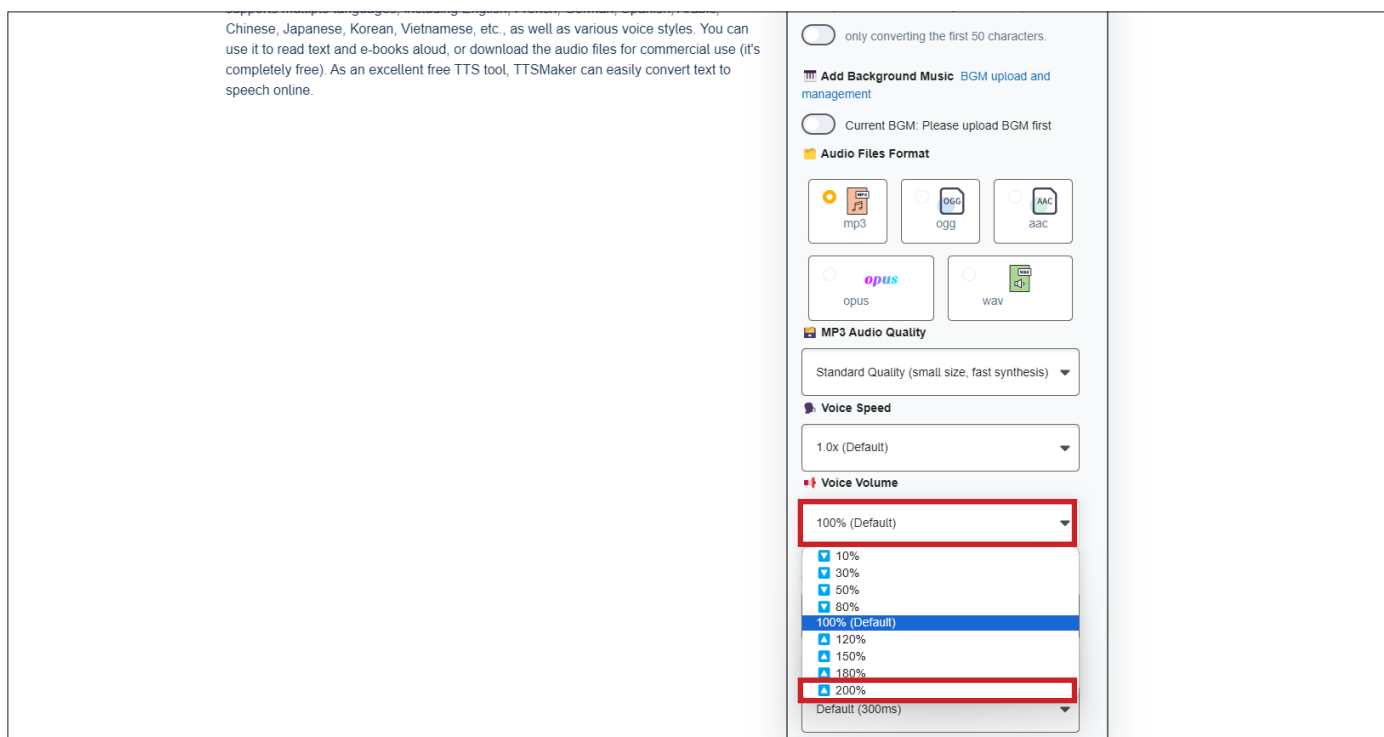

Sect. 12 CREATING TEXT-TO-SPEECH

STEP 5

Fill in the input verification code.

TTSMAKER Free Text to Speech

Maximum characters 3000 remaining 2953 available

Insert Pause

Language: English

Voices:

- 148 - Alayna-usUnited States Female (Hot + Unlimited) [Example] Limit: 3000 Characters
- 777 - Miles-usUnited States Male Voice (Slow + Unlimited) [Example] Limit: 5000 Characters

Input verification code (identify the numbers in the picture): 0868

More Setting Convert To Speech

STEP 6

Then press the convert to speech button.

TTSMAKER Free Text to Speech

Maximum characters 3000 remaining 2953 available

Insert Pause

Language: English

Voices:

- 148 - Alayna-usUnited States Female (Hot + Unlimited) [Example] Limit: 3000 Characters
- 777 - Miles-usUnited States Male Voice (Slow + Unlimited) [Example] Limit: 5000 Characters

Input verification code (identify the numbers in the picture): 0868

More Setting Convert To Speech

STEP 7

Play the desired message. Once you have a message you like, click on the "Download Voice File" button. **NOTE:** Download the file as an MP3 file. The conversion steps on the following pages allows the user to change the MP3 settings and converts to a WAV file, allowing the Parakeet to use the file. **Downloading a WAV file on this stage will still require you to go through the conversion steps on the following pages.**

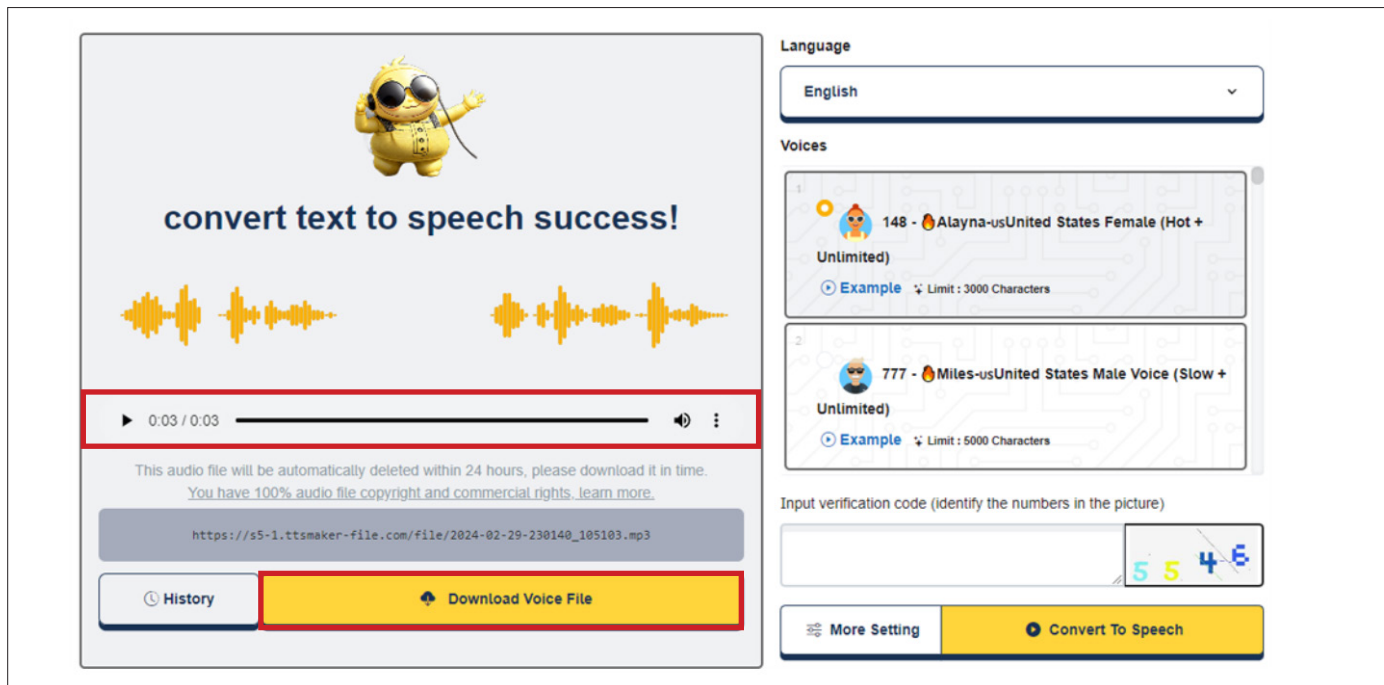

STEP 8

Once your file is downloaded, navigate to your downloads in your file folder. Rename your file to something you would remember. It may be helpful to include a job name, purpose of the message or a date in the name. **NOTE:** If your work zone requires a multi-language message, you will need to generate a message in each language. You will then need to import them into Audacity, a free audio editing program, and combine them into a single file. Please visit www.audacityteam.org to download.

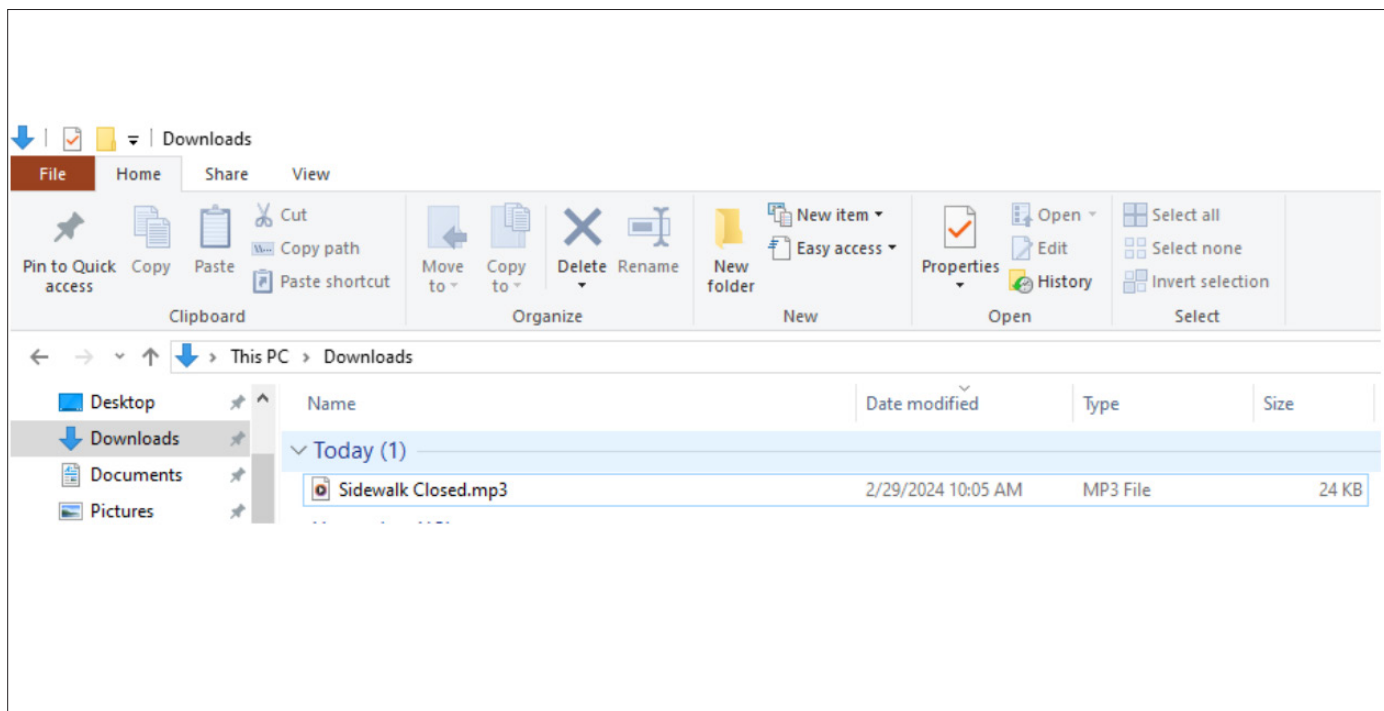

Sect. 12 CREATING TEXT-TO-SPEECH

STEP 9

On your computer, open up your web browser and go to www.onlineaudioconverter.com. **NOTE:** This section may use websites that are blocked on your workplace Internet. If you are experiencing a blocked site, please contact your IT team.



STEP 10

Choose your text-to-speech file from www.ttsmaker.com or other text-to-speech website and upload the file by clicking and dragging into your web browser or click on choose file.

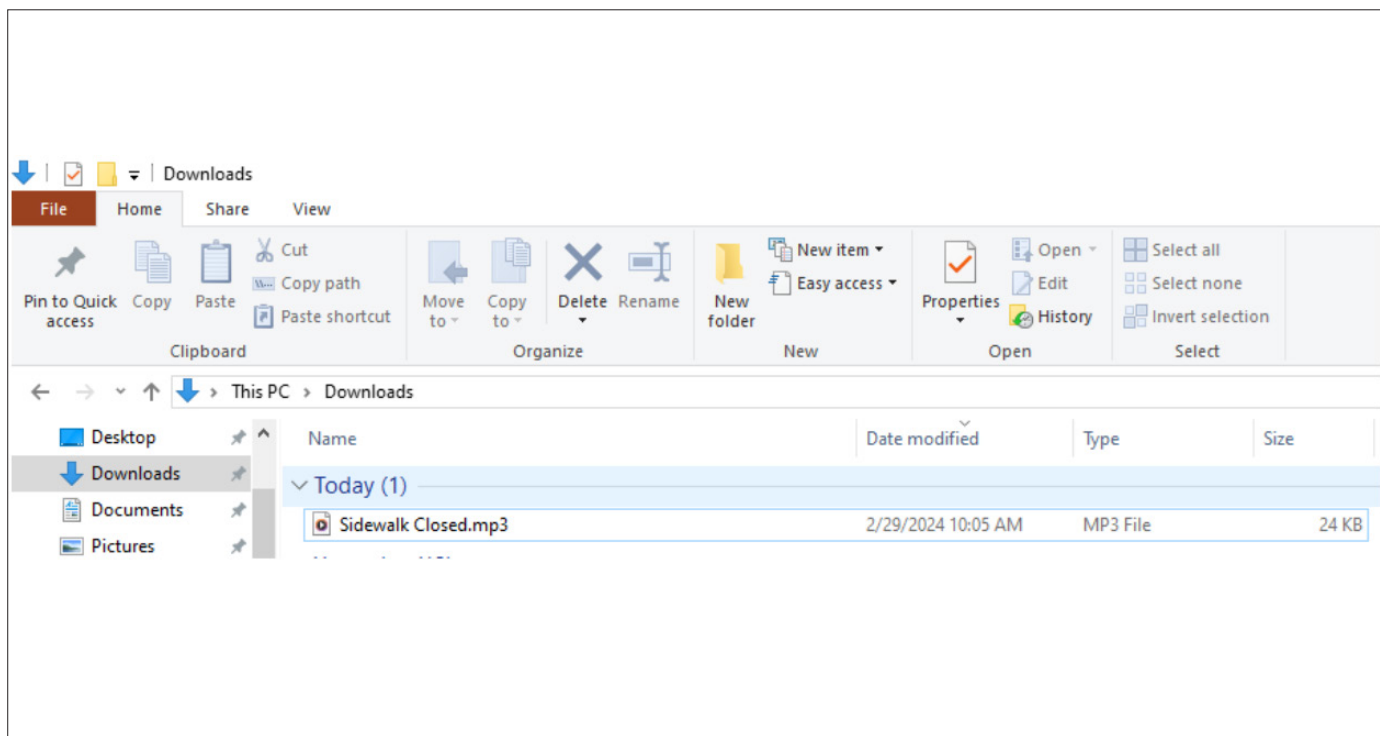

STEP 11

Once the file is uploaded, the file box will show the file name you uploaded. In the bar below the file upload box, select the WAV option to convert the file from an MP3 to a WAV file.

ONLINE AUDIOCONVERTER Convert your audio files to MP3, WAV, FLAC, OGG and more

Audio File Converter | Instant Audio Mastering | Audio Software & Plugins | Learn to Play Piano Online for FREE

Sidewalk Closed.mp3
Click here to select a different file

MP3 WAV FLAC OGG

Quality
64 kbps 128 kbps 256 kbps 320 kbps

Advanced Settings
Default Mono Stereo Channels
Default 24 kHz 32 kHz 44.1 kHz 48 kHz 96 kHz Sample Rate

CONVERT

STEP 12

In the bar below the file conversion box, select the default option for the quality of the file. In the Advanced Settings box, select Mono for the channels and click on the 44.1 kHz for the sample rate.

ONLINE AUDIOCONVERTER Convert your audio files to MP3, WAV, FLAC, OGG and more

Audio File Converter | Instant Audio Mastering | Audio Software & Plugins | Learn to Play Piano Online for FREE

Sidewalk Closed.mp3
Click here to select a different file

MP3 WAV FLAC OGG

Quality
Default 16 bit 24 bit 32 bit

Advanced Settings
Default Mono Stereo Channels
Default 24 kHz 32 kHz 44.1 kHz 48 kHz 96 kHz Sample Rate

CONVERT

Sect. 12 CREATING TEXT-TO-SPEECH

STEP 13

Verify that your settings are as follows: **1. File format - WAV**, **2. Quality - Default**, **3. Channels - Mono**, **4. Sample Rate - 44.1 kHz**. Once you have reviewed your selections, click on the convert button. Once the file has been converted, click on the download button.

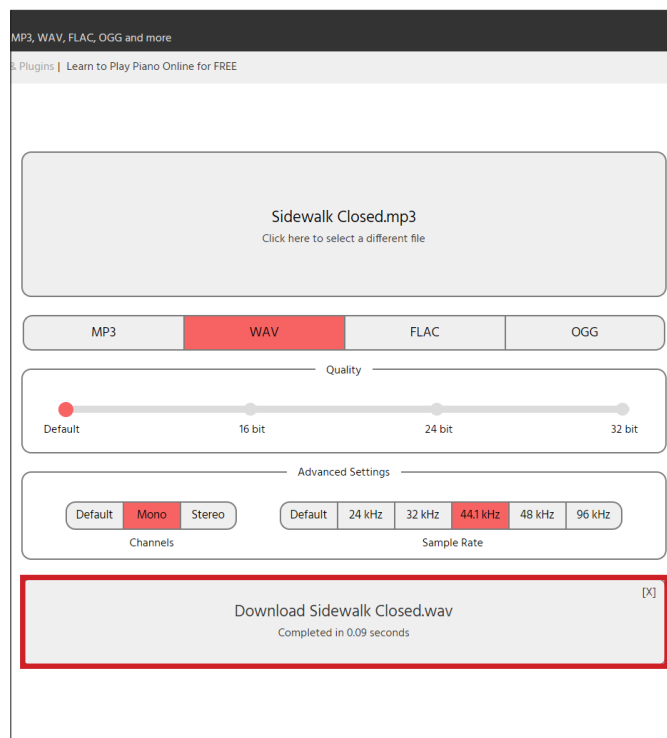
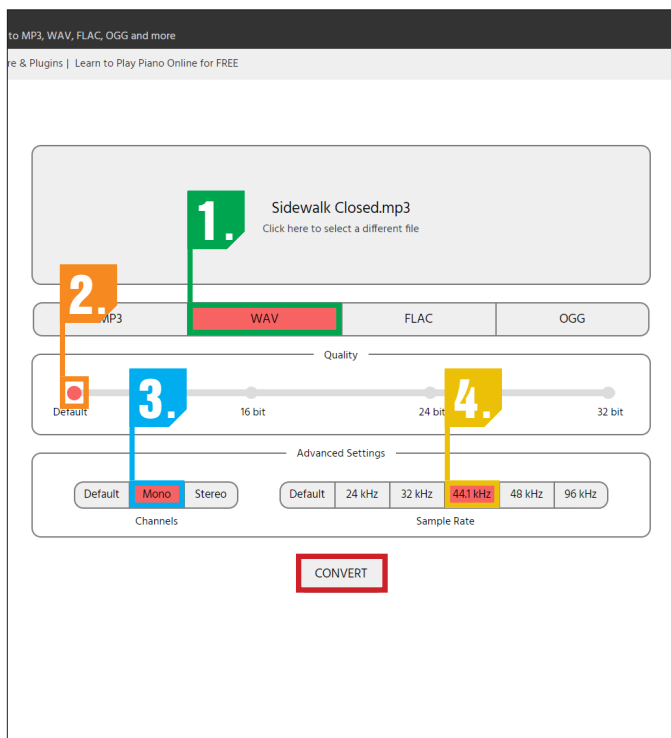

STEP 14

Open the **Parakeet (J)** and press on the **SD Card (V)** on the left side of the unit. Once the SD Card clicks, pinch the edge of the SD Card and pull the card out.

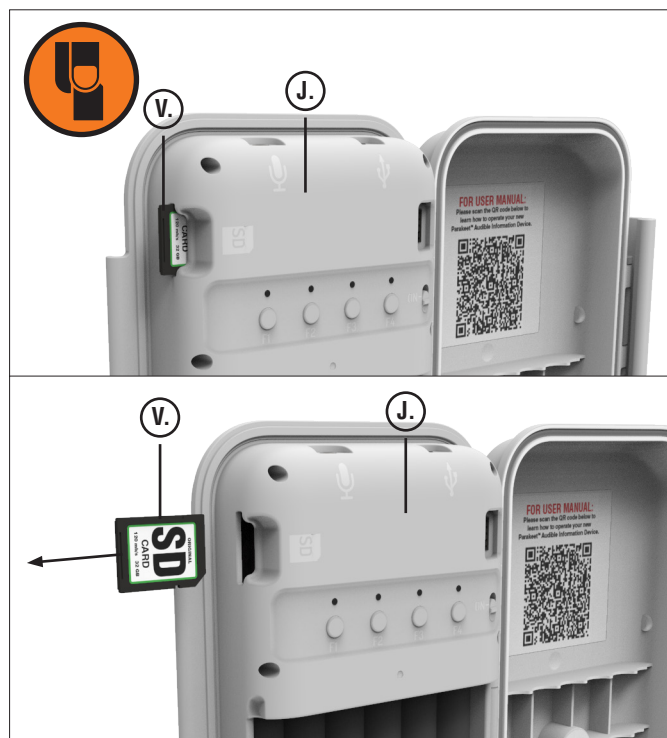
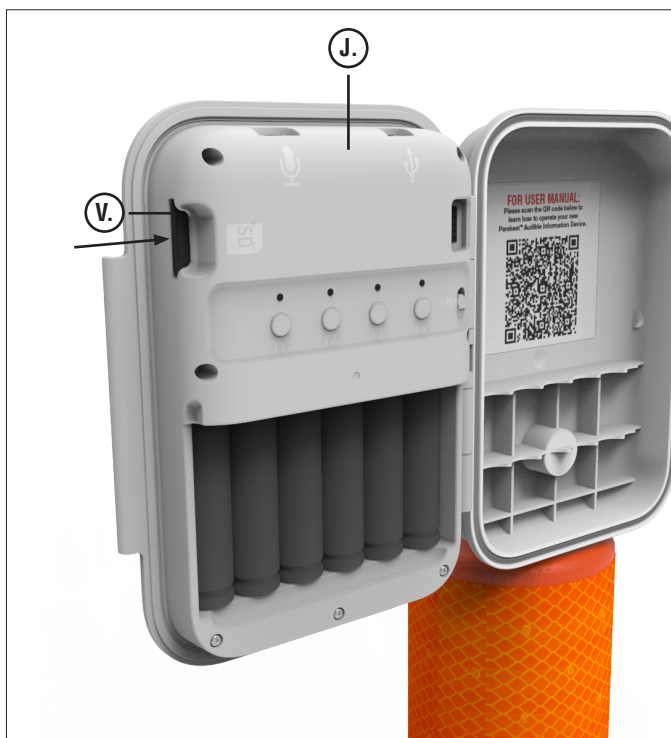

Sect. 12 CREATING TEXT-TO-SPEECH

STEP 15

Insert the **SD Card (V)** into your computer. Delete the existing file named `main_audio.wav` file on the SD Card.

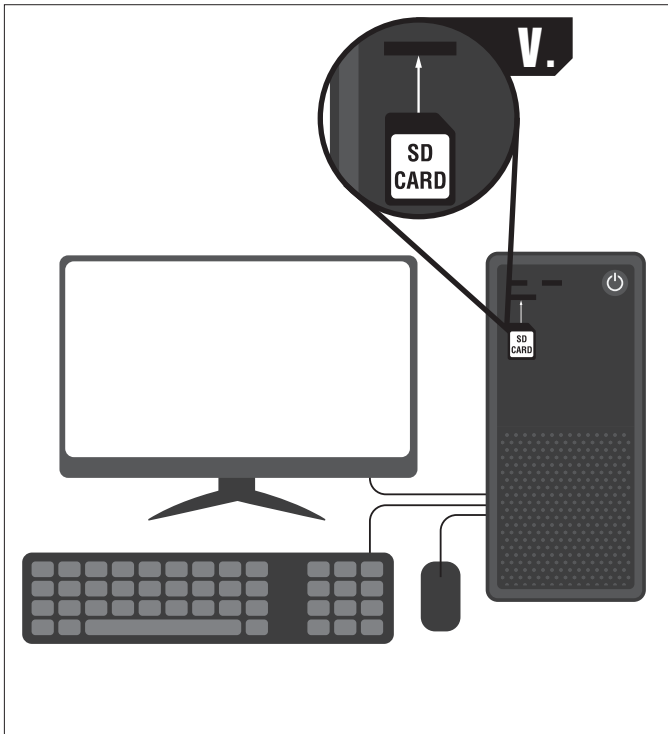

STEP 16

Copy from your download folder the new `main_audio.wav` to the SD Card. Eject the SD Card from your computer.

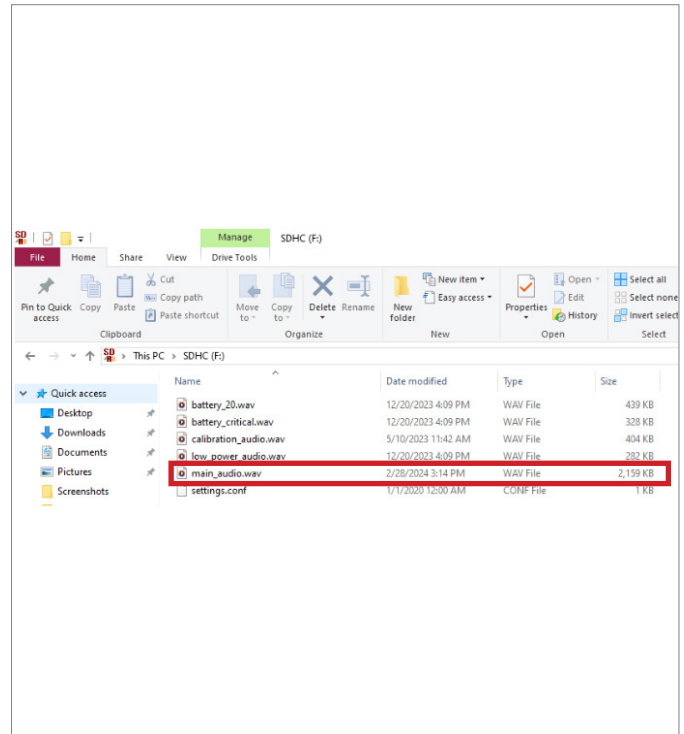

STEP 17

Ensure that your Parakeet is powered off. Insert the **SD Card (V)**. Press on the edge of the SD Card until it clicks then release.

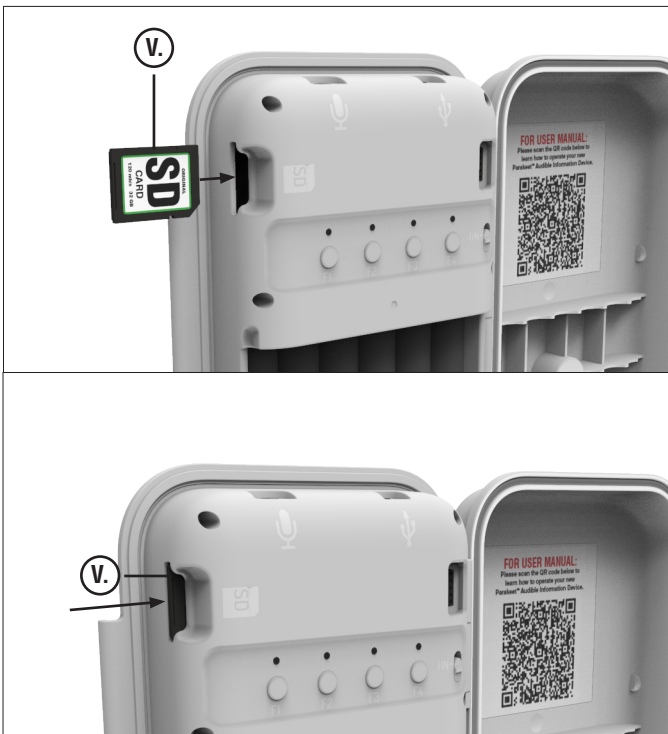

STEP 18

Slide the power switch up into the on position. Your new message on your Parakeet is ready for use. You will need to start the calibration process in section 7 once your Parakeet is in position. Once calibration is complete, your new message will play once the Parakeet is triggered. To raise or lower the base volume, see section 8.

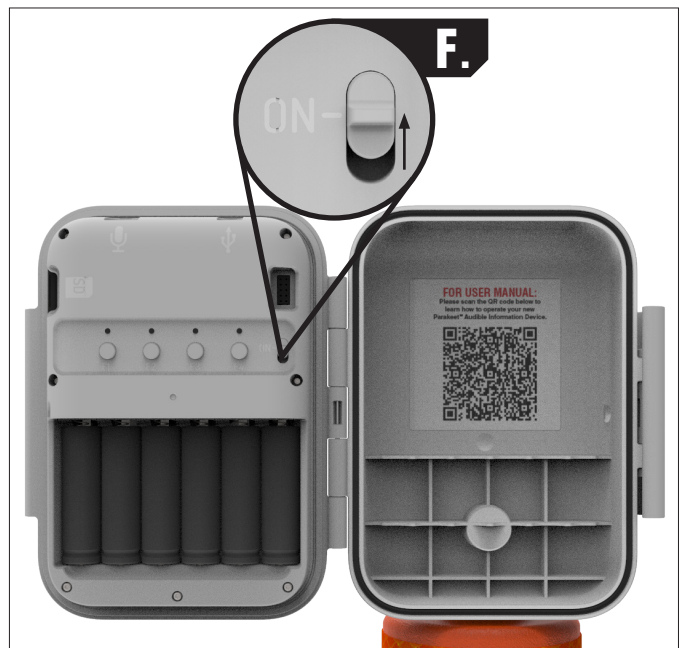

Sect. 13 LOCAL RECORDING

NOTE: Some states have specified the use of text-to-speech recordings and/or standardized messaging on AIDs. Defer to your local agency's standards. For optimal message clarity, PSS recommends using text-to-speech message recordings. For on-site reprogramming of the SD Card, refer to the Parakeet Manual or click [here](#). Quality of local device recordings can vary greatly based on microphone used, background noise, individual voice of person recording, and other factors. For optimal local recording message clarity, record your message indoors or in a quiet location. Microphone is not included.

STEP 1

Plug the **microphone (T)** into the **3.5 mm microphone jack (U)** on the top of the open unit.

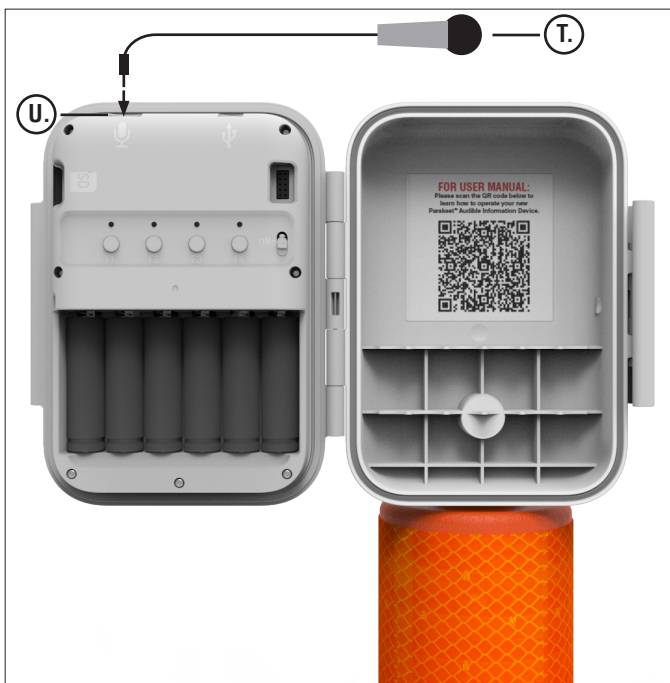

STEP 2

Slide the **power switch (F)** upwards to turn the Parakeet on. Press the **F1 Button (P)**. The LED light above will flash red.

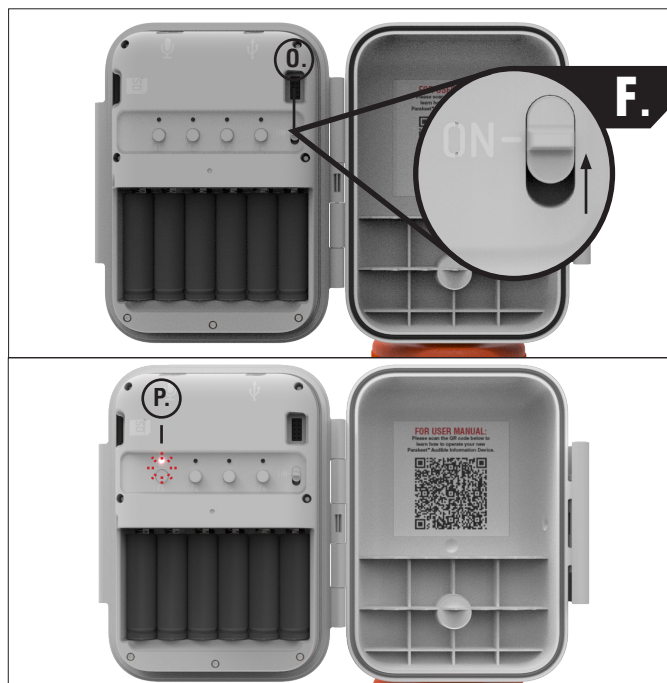

STEP 3

Press and hold the **F3 and F4 buttons (R and S)** simultaneously and wait for all LEDs to turn a steady red. Start speaking clearly and audibly into the **microphone (T)**.



STEP 4

Once you are done recording your message, press the **F4 button (S)** to stop recording.



STEP 5

Parakeet will play the message back and the F1 LED will flash red.

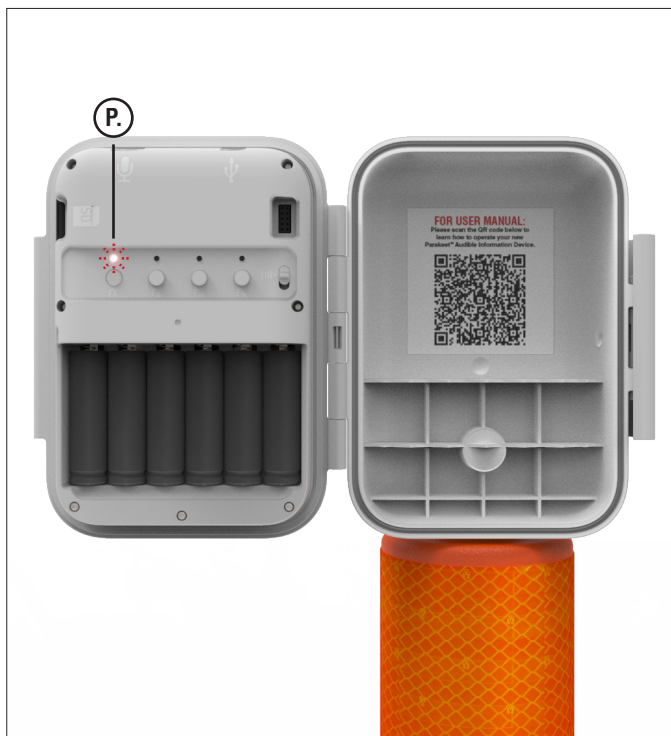
**STEP 6**

If you wish to rerecord your message, press and hold the **F3** and **F4** buttons (**R** and **S**) simultaneously.

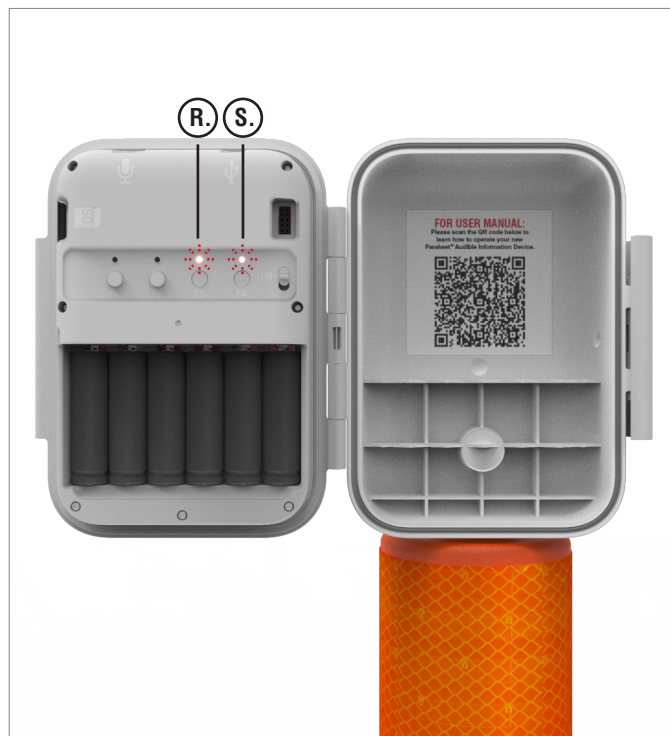
**STEP 7**

Once you are satisfied with your recording, press the **F1** button (**P**) to save the recording and recalibrate the Parakeet. The F1 LED will flash red.

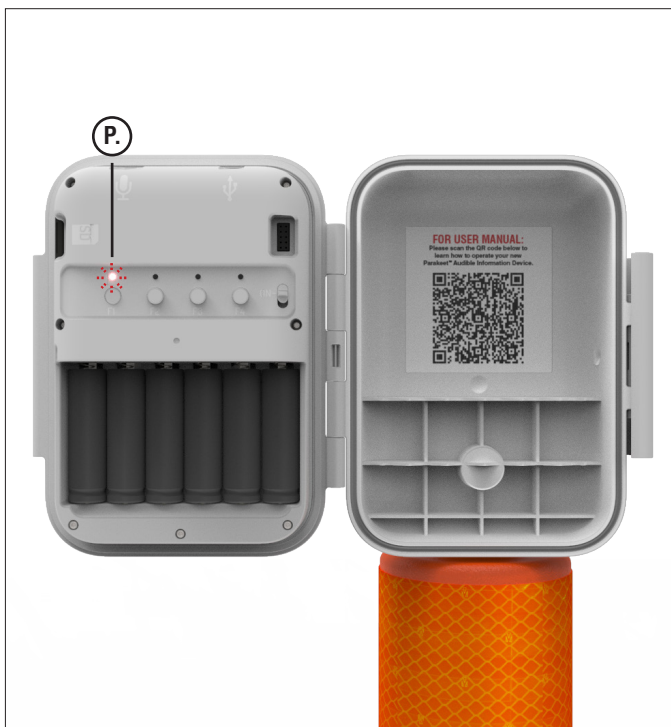

Sect. 14 TROUBLESHOOTING

If your Parakeet becomes unresponsive, talks in a slow or fast cadence, or plays static, your SD Card may be corrupt. Please follow the directions below to fix this issue.

STEP 1

Open your **Parakeet (J)**. Make sure your Parakeet is powered off. Remove the **SD Card (V)** from the side of the unit. (See page 18 for more information).

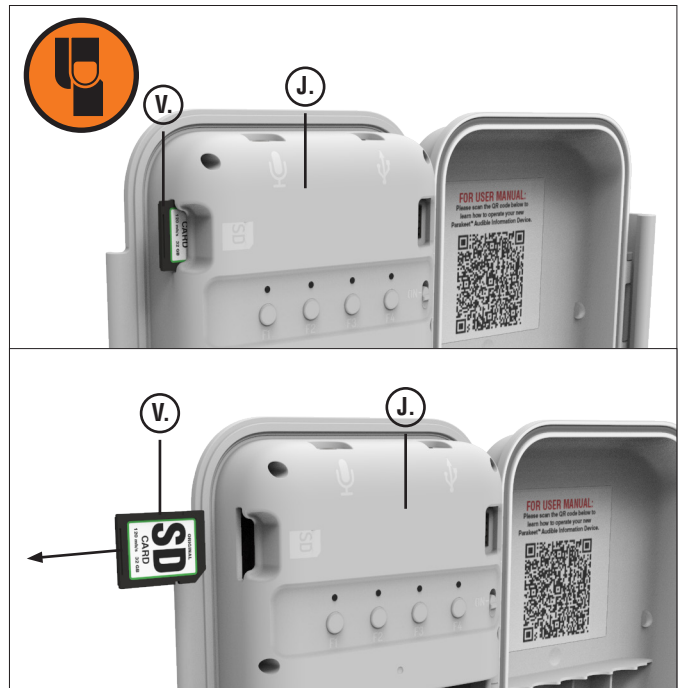
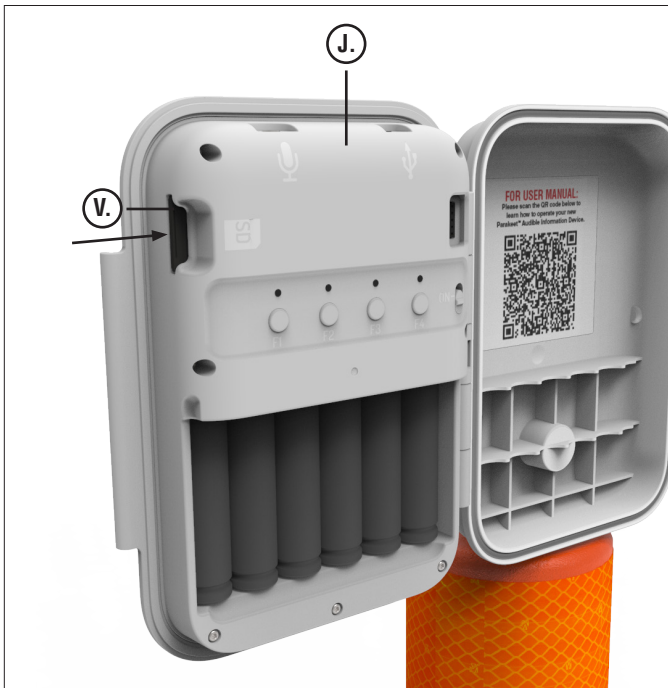

STEP 2

Insert the **SD Card (V)** into the SD Card Reader on your computer.

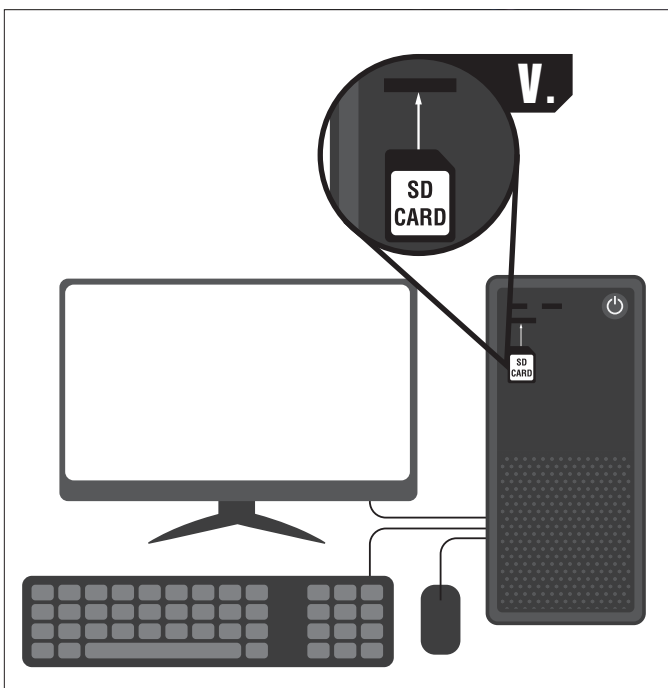

STEP 3

Reformat your SD Card so that the file system is FAT-32. This step will vary between operating systems.

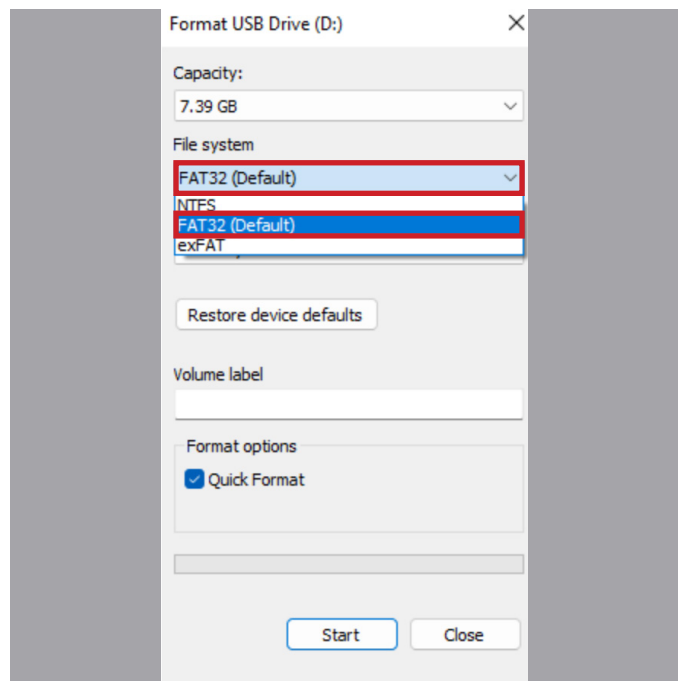

STEP 4

Contact PSS Customer Service at 800-662-6339 to obtain the original Parakeet files. Download the files then copy and paste them onto the newly restored SD Card. Eject the **SD Card (V)** and remove the SD Card from the SD Card Reader. Your SD Card is repaired. This has completely reset the SD Card to factory settings and will play the default message. To change the message, please see section 12 for creating a text-to-speech message or section 13 to record a message locally.

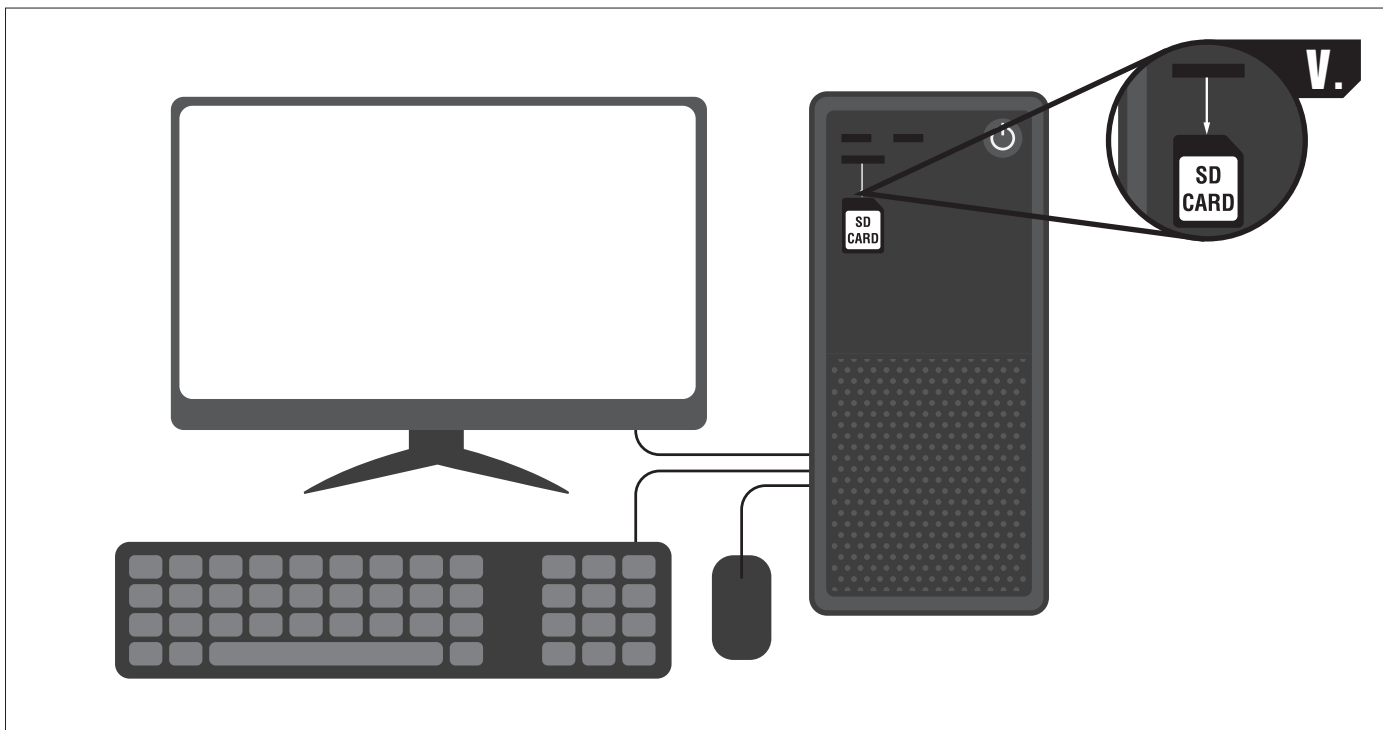



CONTACT:

Call 800-662-6338 to talk to a Customer Service Representative.

HOURS:

8 AM to 5 PM (E.T.)
Monday through Friday

Follow us on:



We don't just talk about Innovations for Safety™ — we live it.

PSS | 2444 Baldwin Road, Cleveland, OH 44104
800-662-6338 | PSS-Innovations.com
Copyright © 2025 | 01/25

**SCAN TO LEARN
MORE ABOUT ALL
PSS HAS TO OFFER**

