

STEP 1

Open the latch your **Parakeet (J)** and fully extend the latch out.

**STEP 2**

Insert a precision flat blade screwdriver into one of the channels in the **locking clip (W)** on the back of the latch.

**STEP 3**

Insert the security bit into the **tamper-resistant screw (B)** on the latch. Turn the screwdriver with the inserted security bit counterclockwise while holding the precision flat blade screwdriver and the **locking clip (W)** in place to remove the screw. The locking clip will now be removable.

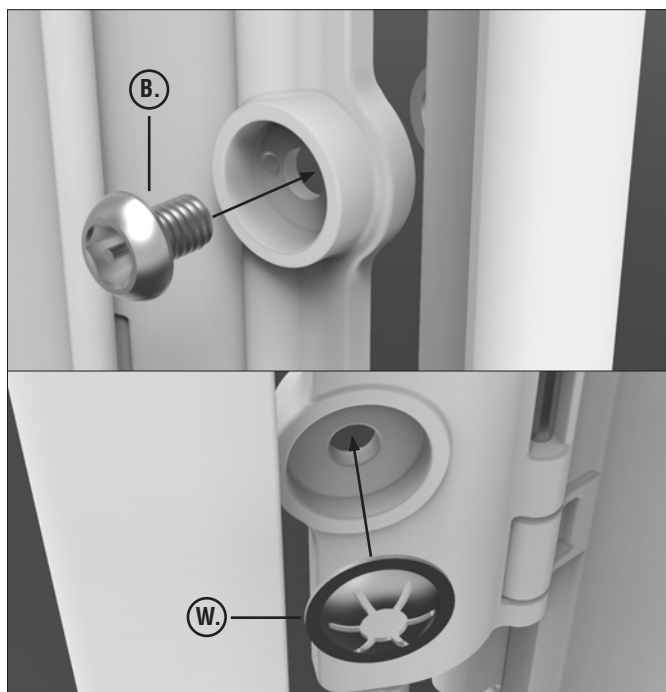

STEP 1

With the latch your **Parakeet (J)** open and fully extend, place the new **locking clip (W)** onto the **brass threaded insert (X)** on the back case of Parakeet, dome side towards the threaded insert.

**STEP 2**

Fold the latch over and ensure that the open hole of the latch lines up with the **locking clip (W)** and **threaded insert (X)**. Close the latch.

**STEP 3**

Thread the **tamper-resistant screw (B)** through the latch, **locking clip (W)** and **brass threaded insert (X)** and tighten until snug.

**STEP 4**

Once snug, turn the screw counterclockwise until it releases from the brass threaded insert and opens the unit.

